



**CONNOR SPORTS**

**HARDWOOD  
SYSTEMS**

**REZILLFLEX™**  
FLOATING SYSTEM



CERTIFIED  
BY THESE  
LEADERS  
IN SPORT



[connorsports.com/hardwood](http://connorsports.com/hardwood)

# REZILLFLEX™

## FLOATING SYSTEM

Connor Sports • 800.283.9522 • 847.290.9020 • info@connorsports.com • connorsports.com/hardwood



RezillFlex pre-assembled subfloor panels are designed to provide especially high shock absorption while controlling the area of deflection.

### REZILLFLEX FLOATING SYSTEM



**Performance Status:**  
Meets or exceeds  
all the requirements  
of DIN 18032, part 2

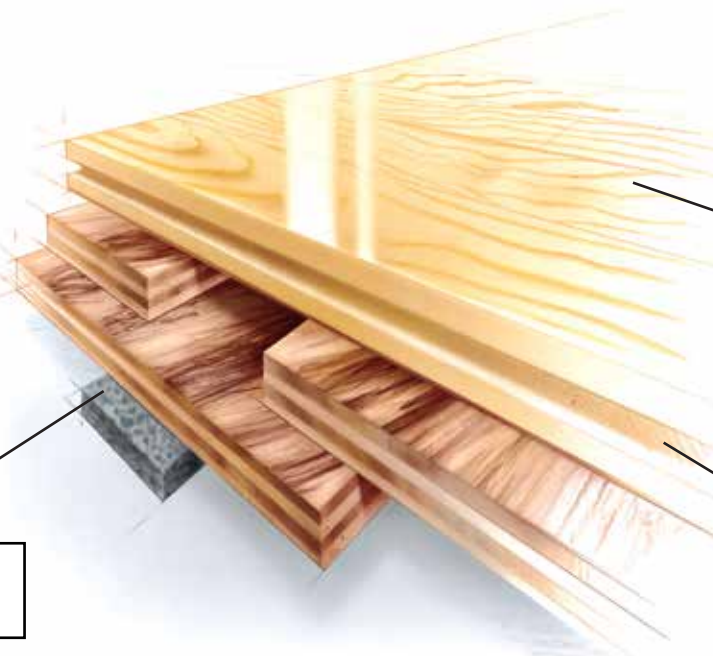

#### RESILIENCE

Rezill Pads for Excellent  
Resilient Life and Loading

#### FLOORING

MFMA Northern  
Hard Maple

#### SUBFLOOR CONSTRUCTION

ISO 9001:2008 Manufactured Underlayment  
Grade Plywood Subfloor Panels

**Slab Depression:** 25/32" (20 mm) flooring - 2 1/8" (54 mm) • 33/32" (26 mm) flooring - 2 3/8" (60 mm)

#### Wall Base Detail

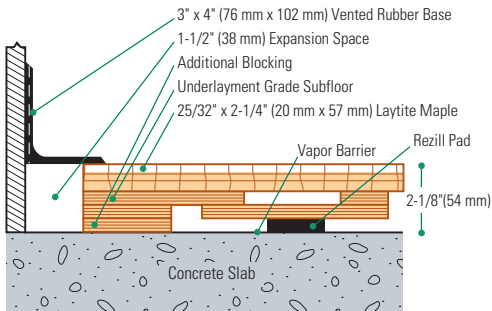

#### Threshold Detail (Optional Accessory)

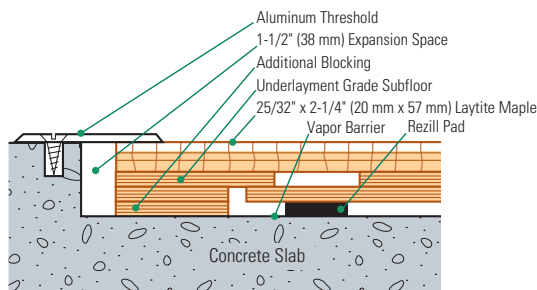

#### Equipment Detail (Optional Accessory)

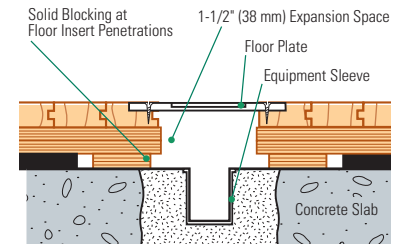

**Manufacturing:**  
ISO 9001:2008  
CERTIFIED  
ISO 14001:2004  
CERTIFIED



**Recycled Contribution:**  
RezillFlex Subfloor System  
includes components with  
recycled content



**Testing Laboratory:**  
United States Sports  
Surfacing Laboratory



**Certified Testing:**  
ISSS Scientific  
Body Membership



**Green Status**  
Managed Forests,  
Certification Available



**Environmental Product Declaration**  
The First Sports Floor Manufacturer to Publish  
UL Certified Product-Specific Environmental  
Performance In Compliance with LEED V.4